

Ergonomics

Footprint

- ▲ 1460 mm (4'9") x 1247 mm (4'1") x 2210 mm (7'3")
- ▲ Table Size: 1185 mm (3'11") x 1206 mm (3'11")
- ▲ Table height: Range 950 mm (3'1") - 1040 mm (3'4") from floor
- ▲ Table front edge position from saw blade 421 mm (1'5") standard
- ▲ Table side width from blade 561 mm (1'10") standard

Cut product movement

- ▲ 561 mm (1'10") table length behind standard table

Operator Interface

- ▲ Positioned in sight line on narrow side of frame
- ▲ Out of cutting zone to avoid distraction
- ▲ Illuminated start/stop buttons
- ▲ LCD display for diagnostics of BladeStop® mechanism
(See BladeStop diagnostics in manual)

Safety

- ▲ Lockout capability at electrical isolator and pneumatic air supply
- ▲ All guards to have coded safety interlock
- ▲ Hinged guards latch open (Interlocked or bolted)
- ▲ Blade guard (Removable stainless steel 304)
- ▲ Interlocked doors will shut down saw if opened while saw is running

Pneumatic Exhaust

- ▲ Low and high pressure relief valves

BladeStop Pneumatic Mechanism

- ▲ Defined as tapered strip jaws
- ▲ Pressure intensifier 7:1
- ▲ BladeStop PCB: version 8.4
- ▲ Supply pressure: min 5.5 bar (80.00 psi)
- ▲ Operator pressure for BladeStop mechanism: 38 bar (558.39 psi) minimum

Glovecheck

- ▲ Color sensitive scanning high frequency vision camera
- ▲ LED placement: in camera enclosure
- ▲ Ethernet port programming on camera

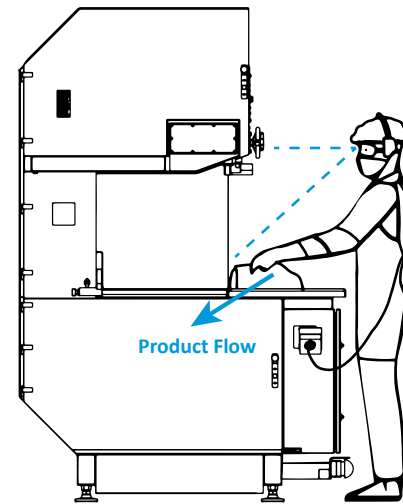

Side to Side stance: Front View

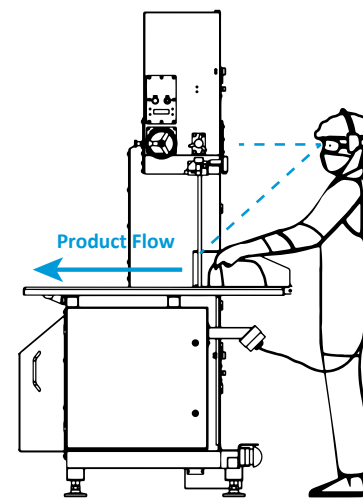

Conventional Stance: Side View

Technical Data and Options Sheet

The BladeStop® bandsaw improves safety and reduces the risk of serious injury by stopping the blade within a fraction of a second. **BladeStop is the fastest stopping bandsaw on the market.** Period. There are two standard safety technologies in the BladeStop bandsaw:

1. Body Sensing Technology, unique to BladeStop, senses the operator's body via the skin contact sensor tethered to the machine. If the operator's body encounters the blade, the sensor will send a signal to mechanically stop the blade, even if the hand or arm is hidden from the camera.



2. GloveCheck identifies the operator's glove via camera in the field of vision closest to the blade, and likewise stops the blade in milliseconds when the glove enters the vision zone. This makes it ideal for high speed and hand-flick cutting tasks.



Laser Guide

- ▲ Provides reference to enable cut accuracy (not shown)

Pneumatic Blade Guard

- Protects blade at adjustable heights via pneumatic actuation (not shown)

Sliding Table

- ▲ Eases movement of protein and cutting accuracy (not shown)



BladeStop Connect

- ▲ Collects real-time data for efficient operations and training

Configuration

- ▲ Configures for left or right hand operators (not both) or side to side (R to L)

Stainless Steel Adjustable Feet 180 mm

- ▲ Enables machine stability and ergonomic adjustments for operator height

Fence Bar Graduated Imperial Scale

- ▲ Enables consistency for thickness of cuts using adjustable scale (not shown)

Air Filter/Dryer Membrane Stainless Steel Enclosure (Mounting location by client)

- ▲ Protects and filters contaminants in pneumatic supply (not shown)

Knee Stop

- ▲ Offers alternative preferences (not shown)

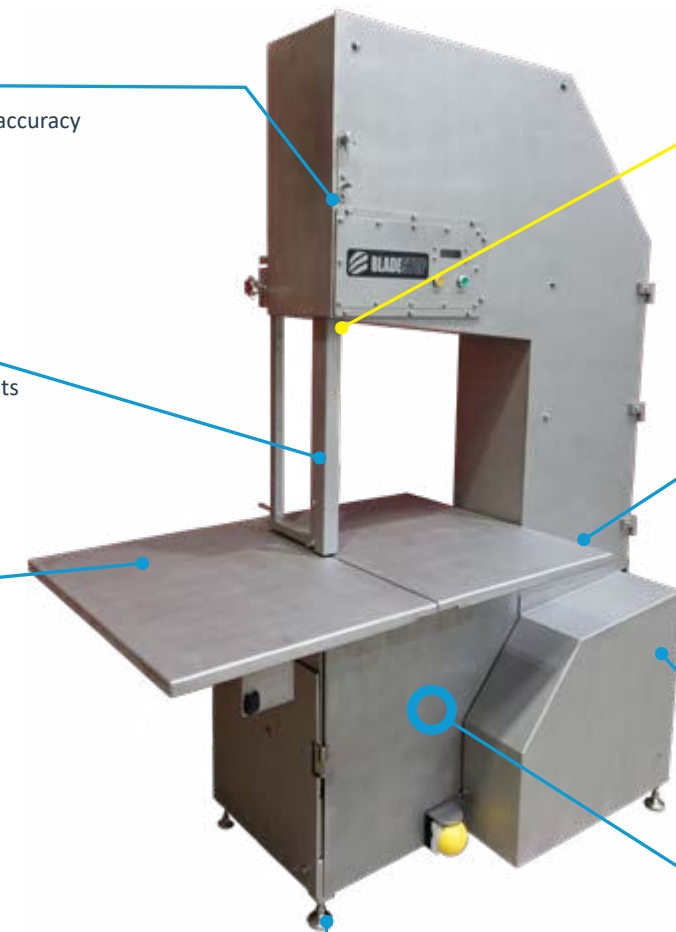

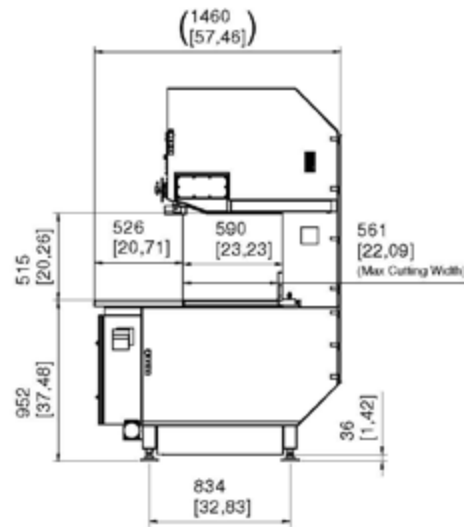

FRONT VIEW

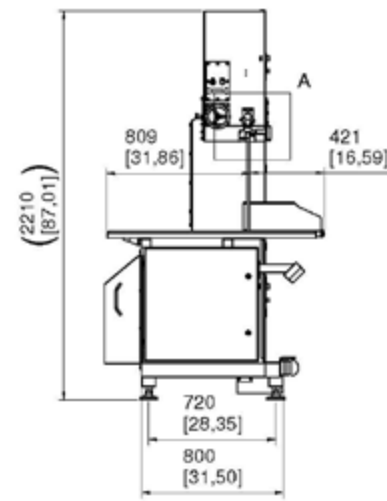

SIDE VIEW

Left Hand Dimensional Drawing Shown

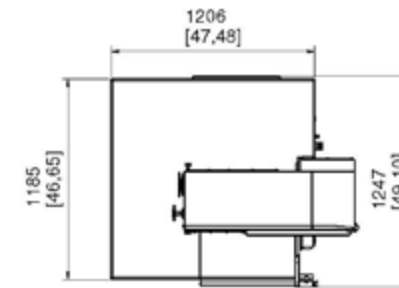

TOP VIEW

Construction - Stainless Steel

- ▲ Frame: 304 or 2205 stainless steel
- ▲ Table stainless steel 316
- ▲ All other stainless steel material
- ▲ 304 stainless

Surface Finish

- ▲ Passivated stainless steel: 2B finish or # 4 finish
- ▲ No painted surfaces
- ▲ No galvanized surfaces

Motors

- ▲ Brake motor, high break duty cycle or continuous brake duty cycle
- ▲ NORD 7.5 KW (10 HP), 3 phase motor
- ▲ Full load current 13.4 / 6.5 A , motor speed 1765 rpm
- ▲ Belt/pulley drive assembly
- ▲ Motor IP: IP55
- ▲ Motor efficiency class IE 3

Electrical Power Requirements

- ▲ 208-600 VAC, 3ph, 50/60 Hz
- ▲ Connector type: IP 66 rated, 4 pin 3 ph 20-40 amp (pending VAC spec)
- ▲ Fault diagnostics as per BladeStop® specification version 8.4 PCB board

Pneumatic Supply

- ▲ 6.5 Bar, 220 lpm, ISO 8573 as class 7.4.4 (clean dry air is required)
- ▲ Supply pressure: 5.5 bar (80.00 psi)
- ▲ Operating pressure: 38 bar (558.39 psi)
- ▲ Volume: 7 CFM per machine

Stability

- ▲ Adjustable feet - standard zinc plated
- ▲ Upgrade stainless steel 304
- ▲ Weight: 750 kg (1653 lb)

Cut Parameters

- ▲ Max cut height: 515 mm (1'8")
- ▲ Max throat depth: 590 mm (1'11")
- ▲ Size range: 19 mm x 0.53 (3/4" x 0.021")

Cutting Blade

- ▲ Size range: 19 mm x 0.53 (3/4" x 0.021")
- ▲ Length: 4500 mm (14'9")
- ▲ Teeth per inch: 3 TPI or pending customer application (smooth or serrated per client specification)

Blade Tension

- ▲ Tension: 1000 N - 780 N
- ▲ Adjustable three prong tension wheel for hand adjustment

Machine Care

Cleaning and hygiene

- ▲ Caustic foam wash and hot rinse capable
- ▲ Water pressure limit: As per IP69

Hygienic Features

- ▲ Internal wash down safe
- ▲ Lifting table
- ▲ Removable dust bin for product waste
- ▲ Electrical panel mounted within double enclosures

Lubrication

- ▲ Lubricated for life bearings
- ▲ Recommend FDA approved grease (Try to avoid food grade as inadequate)

IP Ratings

- ▲ Electrical IP69
- ▲ IP68: BladeStop® control screen, o-ring sealed
- ▲ IP66: Camera enclosed and fiber electrical enclosure
- ▲ IP55: Motor
- ▲ Note condensation build up is not a part of IP ratings and gel packs are used to reduce condensation build up

Regional Compliance

- ▲ CE compliant
- ▲ Full UL compliant
- ▲ ASNZ 4024
- ▲ ASNZ 3000